

Route 10 & North 3rd Street  
Oxford, Pennsylvania

# Oxford Square

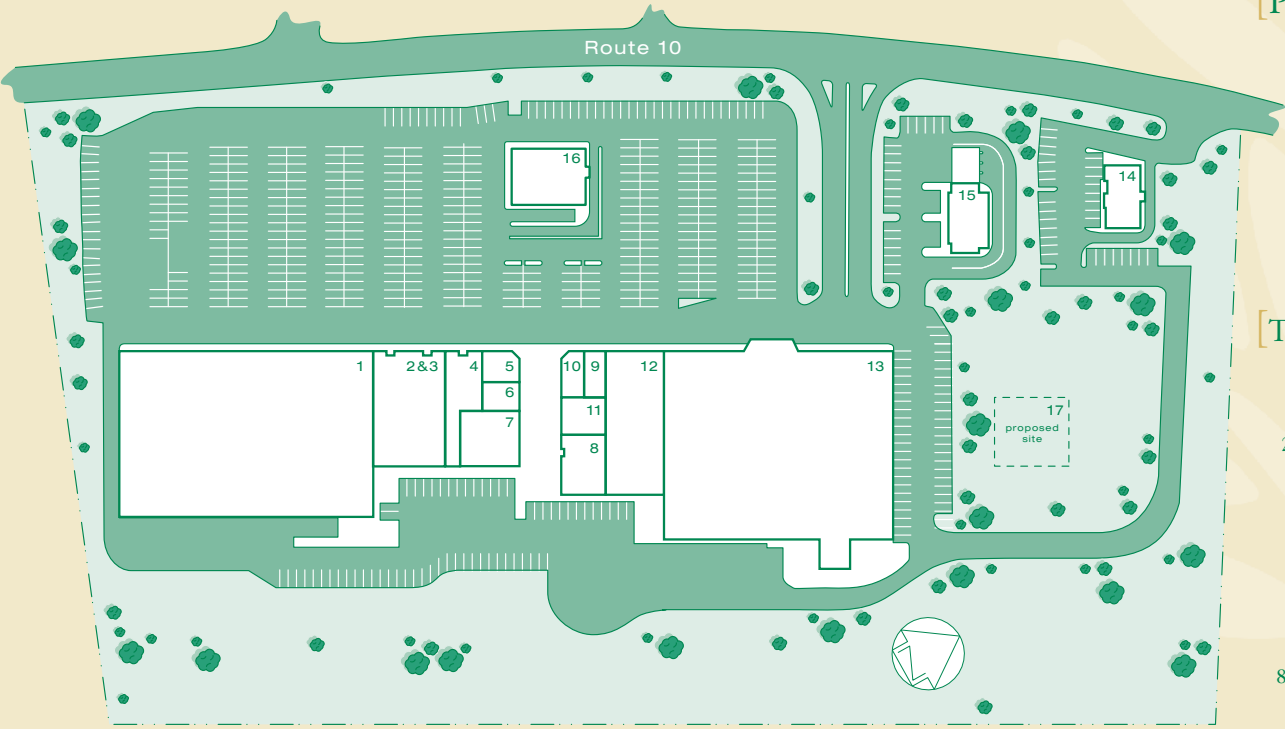

## [PROPERTY HIGHLIGHTS]

- + 119,893 Rentable Square Feet
- + Located in rural Chester County with an expected population growth of 16 percent over the next five (5) years.

## [TENANTS]

- |                              |                              |
|------------------------------|------------------------------|
| 1 Tractor Supply Company     | 10 Hair Express              |
| 2-3 Dollar General           | 12 Rite Aid                  |
| 4 Pat's Pizza                | 13 Redner's Warehouse Market |
| 5 Sonny Bea's                | 14 Verizon Wireless          |
| 6 C & T Nails                | 15 Wendy's                   |
| 7 Oxford Karate              | 16 Dunkin Donuts             |
| 8-11 PA Wine & Spirits Store | 17 <b>Future Development</b> |
| 9 Rita's Water Ice           |                              |

# Oxford Square

## [DEMOGRAPHICS]

	1 mile radius	3 mile radius	5 mile radius
Population	4,637	15,363	26,442
Average Household Income	\$46,418	\$62,746	\$70,446

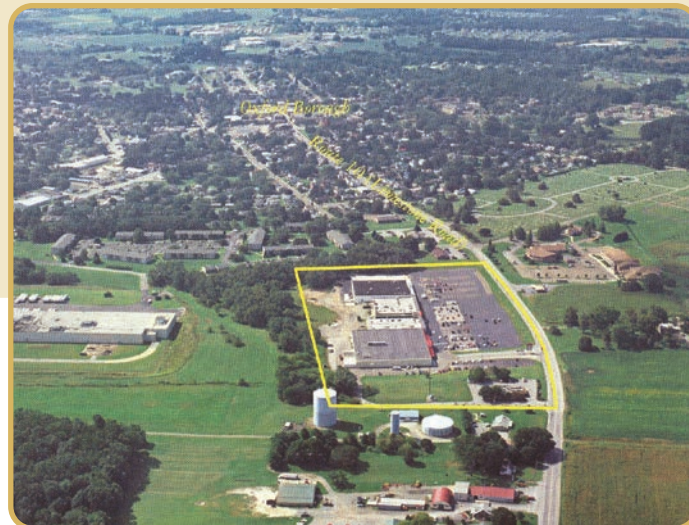

For More Information Contact  
 Dave McManus  
 610.337.3994  
 dmcmanus@westovercompanies.com

*Information contained herein has been obtained from the owner of the property or from sources deemed reliable. We have no reason to doubt its accuracy but make no warranty or representation. All information is submitted subject to errors, omissions, changes, withdrawal without notice and any special listing conditions of the owner.*

PROFESSIONALLY  MANAGED BY

The Westover Management Companies  
 550 American Ave. • Suite 1 • King of Prussia, PA 19406  
 610.337.3994 phone • 610.337.2206 fax  
 www.westovercompanies.com